



\$ 525,000.00

342 W 160 N BLACKFOOT

<https://seidahorealestate.com>

****THIS PROPERTY IS CURRENTLY UNDER CONTRACT WITH CONTINGENCIES**SELLER ACCEPTING BACKUP OFFERS****Beautiful new construction home in the highly sought-after Wildflower subdivision, in peaceful Groveland. This gorgeous quality home is being built with true craftsmanship. You will enjoy entertaining, relaxing, growing, and creating in this modern-organic style, open concept home. The exterior...

342 W 160 N BLACKFOOT ID
83221

- 3 beds
- 2 baths
- Single Family
- Residential
- Active

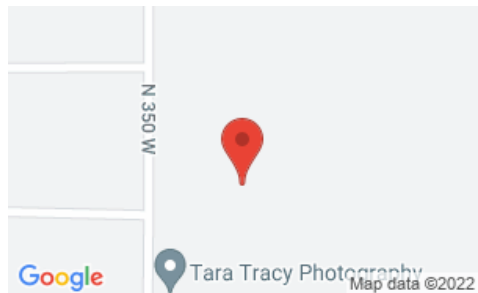

CALL US NOW

Phone: 2088212832
Email: dustin@seidahorealestate.com
Address: 1515 Ashment ave #3 Idaho Falls, ID 83404



Dustin Hawkins
Local Realtor
208 821 2832
dustin@seidahorealestate.com

BASIC FACTS

Days on Market: 4

Type: Single Family

Bathrooms: 2

Area: 3383 sq ft

Heat Source/Type: Gas

Abv Grade SqFt: 1733

Status: Active

Bedrooms: 3

Apx Acreage: 0.35

Year built: 2022

Air Conditioning: Other-See Remarks

Basement: Full,Unfinished

TAXES AND FEES

Taxes: 99.72

Tax Year: 2020

HOA Paid: Yearly

HO Exempt: Not Exempt

Association Fee Includes: Other-See Remarks



CALL US NOW

Phone: 2088212832

Email: dustin@seidahorealestate.com

Address: 1515 Ashment ave #3 Idaho Falls, ID 83404



Dustin Hawkins
Local Realtor
208 821 2832
dustin@seidahorealestate.com